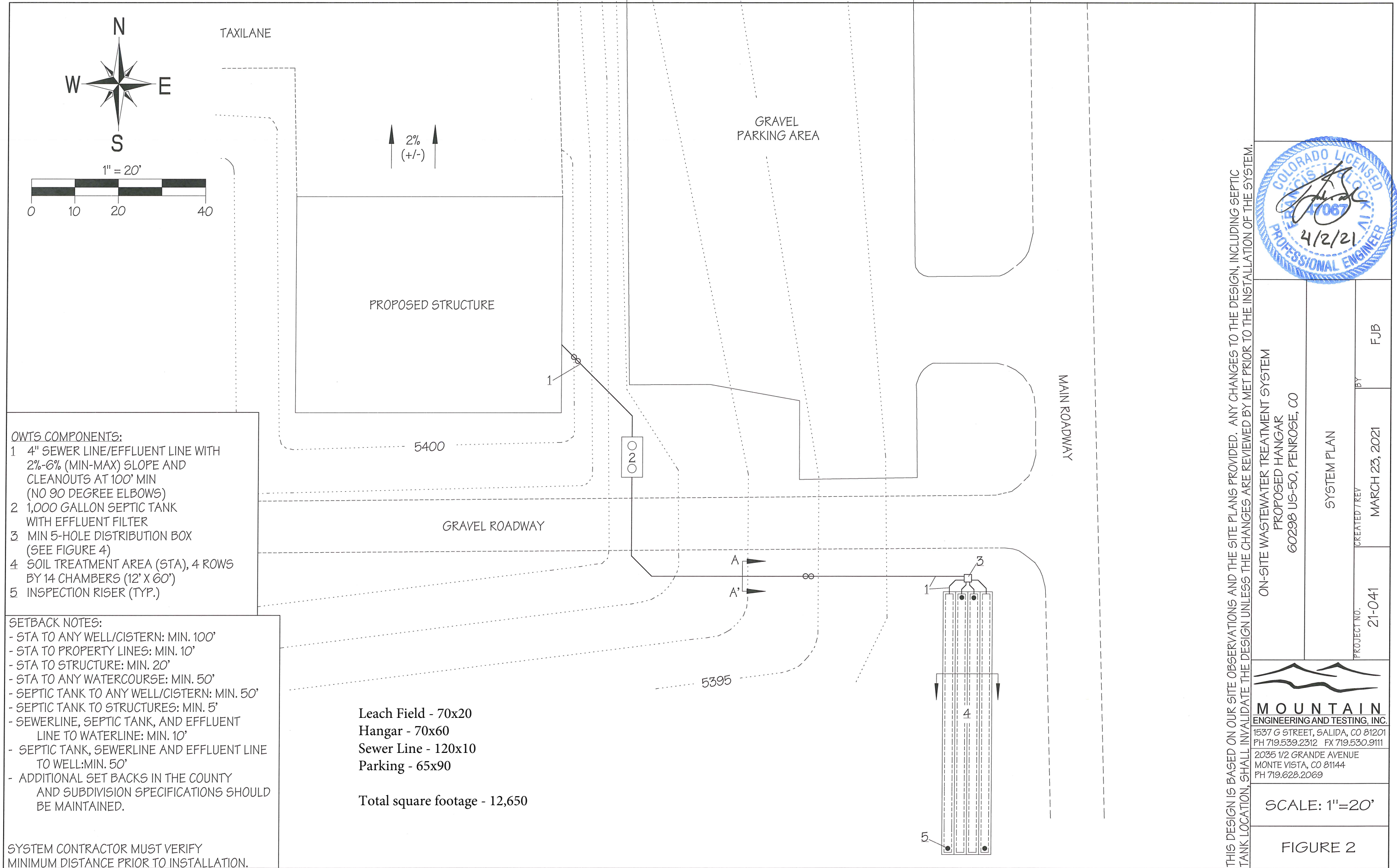

Exhibit A



- OWTS COMPONENTS:**
- 1 4" SEWER LINE/EFFLUENT LINE WITH 2%-6% (MIN-MAX) SLOPE AND CLEANOUTS AT 100' MIN (NO 90 DEGREE ELBOWS)
 - 2 1,000 GALLON SEPTIC TANK WITH EFFLUENT FILTER
 - 3 MIN 5-HOLE DISTRIBUTION BOX (SEE FIGURE 4)
 - 4 SOIL TREATMENT AREA (STA), 4 ROWS BY 14 CHAMBERS (12' X 60')
 - 5 INSPECTION RISER (TYP.)

- SETBACK NOTES:**
- STA TO ANY WELL/CISTERN: MIN. 100'
 - STA TO PROPERTY LINES: MIN. 10'
 - STA TO STRUCTURE: MIN. 20'
 - STA TO ANY WATERCOURSE: MIN. 50'
 - SEPTIC TANK TO ANY WELL/CISTERN: MIN. 50'
 - SEPTIC TANK TO STRUCTURES: MIN. 5'
 - SEWERLINE, SEPTIC TANK, AND EFFLUENT LINE TO WATERLINE: MIN. 10'
 - SEPTIC TANK, SEWERLINE AND EFFLUENT LINE TO WELL: MIN. 50'
 - ADDITIONAL SET BACKS IN THE COUNTY AND SUBDIVISION SPECIFICATIONS SHOULD BE MAINTAINED.

Leach Field - 70x20
 Hangar - 70x60
 Sewer Line - 120x10
 Parking - 65x90

 Total square footage - 12,650

SYSTEM CONTRACTOR MUST VERIFY MINIMUM DISTANCE PRIOR TO INSTALLATION.

THIS DESIGN IS BASED ON OUR SITE OBSERVATIONS AND THE SITE PLANS PROVIDED. ANY CHANGES TO THE DESIGN, INCLUDING SEPTIC TANK LOCATION, SHALL INVALIDATE THE DESIGN UNLESS THE CHANGES ARE REVIEWED BY MET PRIOR TO THE INSTALLATION OF THE SYSTEM.

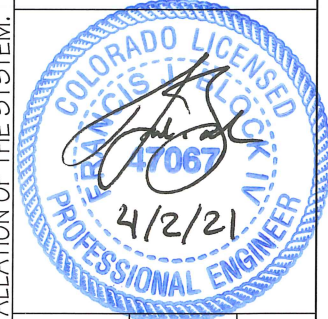

ON-SITE WASTEWATER TREATMENT SYSTEM PROPOSED HANGAR 60298 US-50, PENROSE, CO	
PROJECT NO. 21-041	CREATED / REV MARCH 23, 2021
SYSTEM PLAN	
BY FJB	

MOUNTAIN
 ENGINEERING AND TESTING, INC.
 1537 G STREET, SALIDA, CO 81201
 PH 719.539.2312 FX 719.530.9111
 2035 1/2 GRANDE AVENUE
 MONTE VISTA, CO 81144
 PH 719.628.2069

SCALE: 1"=20'

FIGURE 2